



**FC-M805  
FC-M800**

Front chainwheel

## General Safety Information

### **⚠ WARNING**

- **Off-road bicycle riding and extreme mountain bike riding, represented in part by North Shore style riding, “trials riding”, or urban stunt riding is an inherently dangerous activity. There is a risk of being involved in an accident that can result in a serious injury or even death. It is strongly recommended that riders wear protective head and body gear and perform thorough safety checks of their bicycles before riding. Please remember that you are riding at your own risk and that you have to consider your experience and your skills very carefully.**
- The FC-M805/FC-M800 crankset is designed for off-road bicycle riding and extreme mountain bike riding, that are represented in part by North Shore style riding, “trials riding”, or urban stunt riding. However, depending on the riding conditions, a crank or a bottom bracket axle can develop a crack, which may result in the failure of the crank. This can lead to an accident that could result in a serious injury or even death.
- Before riding, you should carefully check your crankset to make sure that there are no cracks, and if you find any sign of a crack or any other unusual condition, do NOT use the bicycle.
- Be careful not to let the cuffs of your clothes get caught in the chain while riding, otherwise you may fall off the bicycle.
- Check that the tension of the chain is correct and that the chain is not damaged. If the tension is too weak or the chain is damaged, the chain should be replaced. If this is not done, the chain may break cause serious injury.
- Obtain and read the service instructions carefully prior to installing the parts. Loose, worn, or damaged parts may cause injury to the rider.  
We strongly recommend only using genuine Shimano replacement parts.
- Read these Technical Service Instructions carefully, and keep them in a safe place for later reference.

### Note

- Turn the top adjustment screw to adjust so that the chain does not sit on top of the bash guard.
- Make sure that the chainring combination matches the front chainwheel tooth configuration in the Product specifications table. If other combinations are used, the distance between the chainrings will be incorrect and the chain might slip off and get caught in between them.
- When the chain is in the position shown in the illustration, the chain may contact the front chainrings or front derailleur and generate noise. If the noise is a problem, shift the chain onto the next-larger rear sprocket or the one after.
- Check that there is no looseness in any joints or connections before riding the bicycle. (BB-FC, FC-PD)
- If you feel any looseness in the bottom bracket axle, the bottom bracket should be replaced.
- In addition, if pedaling performance does not feel normal, check this once more.
- Do not wash the bottom bracket with high-pressure jets of water.
- Apply grease to the bottom bracket before installing it.
- To ensure the best performance, be sure to use only the specified type of chain. The wide type of chain cannot be used.
- If the chain keeps coming off the chainrings during use, replace the chainrings and the chain.
- You should periodically wash the chainrings in a neutral detergent and then lubricate them again. In addition, cleaning the chain with neutral detergent and lubricating it can be an effective way of extending the useful life of the chainrings and the chain.
- This product is not warranted against damage resulting from use such as jumping while riding or if the bicycle falls over, except if such malfunctions result from non conforming materials or manufacturing methods.
- Parts are not guaranteed against natural wear or deterioration resulting from normal use.
- For maximum performance we highly recommend Shimano lubricants and maintenance products.
- For any questions regarding methods of installation, adjustment, maintenance or operation, please contact a professional bicycle dealer.

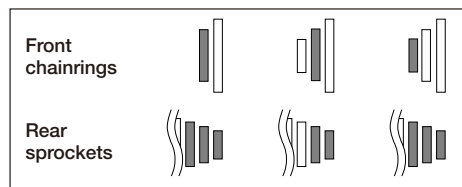

## Specifications

Type	Triple	Double	Single
Model number	FC-M805-3 FC-M800-3	FC-M805-2 FC-M800-2	FC-M805-1 FC-M800-1
Chainwheel tooth combination	44-32-22T	32-22T	34/38/42/46T
Bolt circle diameter	104 / 64 mm		
Crank arm length	165, 170, 175, 180 mm		
Pedal threads	B.C. 9/16" x 20T.P.I. (English thread)		
Applicable chain	CN-7701		

Model number	Chain line	Shell width (Thread dimensions)
FC-M805-3, FC-M805-2 FC-M805-1	57.5 mm	83 mm (1.37 X 24 T.P.I.)
FC-M800-3, FC-M800-2 FC-M800-1	50 mm	68, 73 mm (1.37 X 24 T.P.I.)

## Installation of the front chainwheel

Follow the procedure in the figure.

- 1, 2 Use the special tool TL-FC32 to install the right adapter (counterclockwise thread) and the left adapter (clockwise thread).  
Tightening torque: 35 - 50 N·m {305 - 435 in. lbs.}
- 3 Insert the right crank unit.
- 4 Set section A of the left crank into the axle of the right crank unit where the groove is wide.
- 5 Use the TL-FC16 to tighten the cap.  
Tightening torque: 0.7 - 1.5 N·m {6 - 13 in. lbs.}
- 6 Tighten the bolt of the left crank.

**Note :** Each of the bolts should be evenly and equally tightened to 12 - 15 N·m {106 - 132 in. lbs.}.

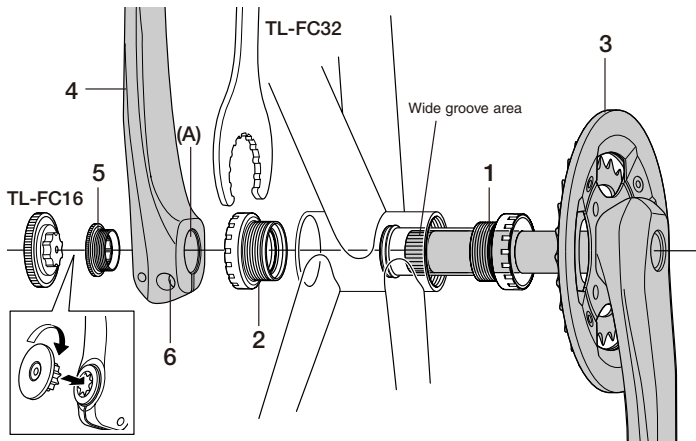

## ■ Spacer installation method

- (1) Check whether the width of the bottom bracket shell is 68 mm, 73 mm or 83 mm.
- (2) Next, install the adapter while referring to the illustrations below.

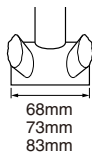

### <FC-M800>

Band Type	Bracket Type
<p>68 mm</p>	<p>68 mm E-type bracket</p>
<p>73 mm</p>	<p>73 mm</p>

### <FC-M805>

Band Type	Bracket Type
<p>83 mm</p>	<p>83 mm E-type bracket</p>

### For bracket type

Install as shown in the illustration.

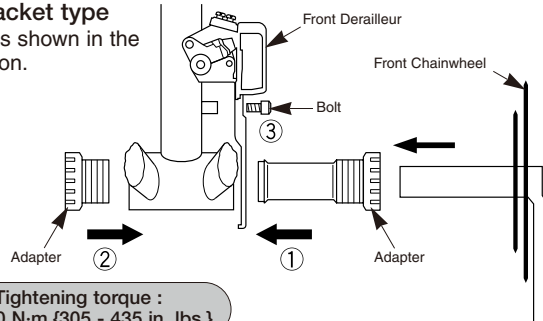

Tightening torque :  
35 - 50 N·m {305 - 435 in. lbs.}

When installing the pedals, be sure to place pedal spacers on both the left and right crank arms.

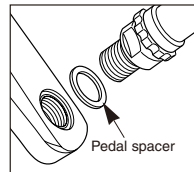

## Installation of the front derailleur

### For double chainwheel

Adjust as show in the illustration and then install the front derailleur.

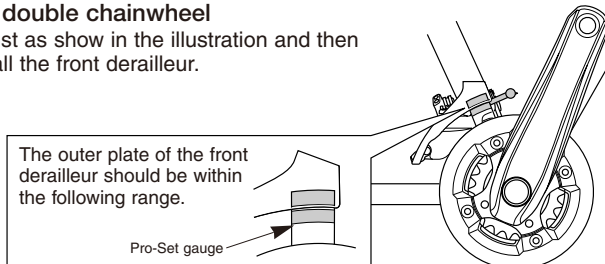

- Be sure to read the Service Instructions for the front derailleur being used together with these instructions.

# SHIMANO

SHIMANO AMERICAN CORPORATION  
One Holland, Irvine, California 92618, U.S.A. Phone: +1-949-951-5003

SHIMANO EUROPE HOLDING B.V.  
Industrieweg 24, 8071 CT Nunspeet, The Netherlands Phone: +31-341-272222

SHIMANO INC.  
3-77 Oimatsu-cho, Sakai, Osaka 590-8577, Japan

Please note: specifications are subject to change for improvement without notice. (English)  
© May, 2004 by Shimano Inc. XBC SZK Printed in Japan

